



5500 & 7700 Series Half Mask Air-Purifying Respirator User's Instructions

Serie 5500 & 7700 Respirador Purificador De Media Máscara Manual de Instrucción

Série 5500 & 7700 Respirateur de filtration d'air a masque bucco-nasal Guide d'utilisation



© 2006 North Safety Products Printed in U.S.A. Part No. 46000375 Rev. D

REPLACEMENT PARTS PIEZAS DE REPUESTO PIÈCES DE REMPLACEMENT 7700 & 5500 Series Facepiece Replacement Parts

Product Number	Description
770030 L, M, S	Silicone Half Mask
550030 L, M, S	Elastomeric Half Mask

Replacement Parts	Product Number	Description
1a	770011 L, M, S	Basic Facepiece for 7700
1b	550011 L, M, S	Basic Facepiece for 5500
2	770016	Cartridge Connector
3	770017	Inhalation Valve
4	770019	Exhalation Valve Seat
5	770018	Exhalation Valve
6	770020	Exhalation Valve Guard
7	770092	Cradle Suspension System

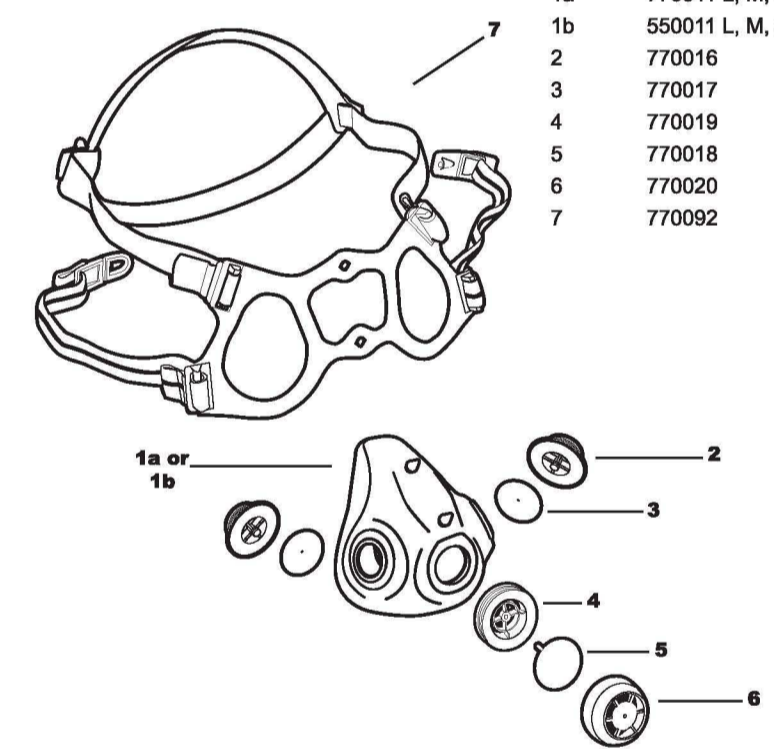

ASSEMBLING THE RESPIRATOR ENSAMBLANDO EL RESPIRADOR ASSEMBLER LE RESPIRATEUR



1

2



3

4

PUTTING ON THE RESPIRATOR COLOCANDO EL RESPIRADOR MISE EN PLACE DU RESPIRATEUR



5

6



7

8

PUTTING ON THE RESPIRATOR COLOCANDO EL RESPIRADOR MISE EN PLACE DU RESPIRATEUR



9

10



11

12

PUTTING ON THE RESPIRATOR

Only put on your respirator in an area with uncontaminated air. Visually check the respirator to make sure all major components are in place and in working condition. Verify the correct cartridges and/or filters are being used and they are securely attached to the facepiece. Use a mirror to assure the respirator is positioned correctly on your face. Remove eyewear, hard hat or other head gear before putting on the respirator. Replace after you put on the respirator.

- Adjust the respirator head straps and clips to their full outward position.
- With one hand holding the respirator, place your chin inside the chin cup and the top of the respirator over your nose (Photo 5). If using the Backpack Adapter, the breathing tubes will go over your head and rest on your shoulders.
- With the other hand, position the plastic straps so they are centered on your head (Photo 6). Remove any slack in the upper straps by pulling the two end tabs, back and toward your ears (Photo 7). Do not tighten.
- Fasten the bottom elastic straps behind your neck and under your hair. Remove any slack in the bottom straps by pulling the end tabs (Photo 8). Do not tighten.
- Tighten the upper head straps in small equal increments to ensure the top half of the respirator is tightened evenly and it is snug, comfortable and centered on your face (Photo 9).
- Tighten the lower head straps by pulling evenly on the end straps in the back of the respirator until the entire respirator is snug, comfortable and centered on your face (Photo 10).
- Pull the respirator away from your face and maneuver it to assure it's centered, comfortable and snug (Photo 11). A final small adjustment may be made, by again tightening the upper and lower straps.
- The plastic loops on the top straps slide back to hold down any loose strap material.

NOTES

The tightness of the respirator will vary depending on the cartridges and/or filters used and the user's level of activity while the respirator is in use. When using combination cartridges and/or during high levels of activity, the respirator should be reasonably tight to the face to assure it does not move during use. Be careful not to over tighten the respirator. Over tightening could distort the facepiece seal and may cause leakage.

Your supervisor or safety director should assist you to determine how tight the respirator should be on your face. Ultimately the user will have the best sense as to when the respirator needs to be adjusted and how tight a fit is needed to ensure a good face-to-facepiece seal, prior to and during use.

FACE-TO-FACEPIECE SEAL CHECK

Each time you put on the respirator, before entering an area containing hazardous atmospheres, and periodically while wearing the respirator in the contaminated area, check the effectiveness of the face-to-facepiece seal by carrying out a positive pressure seal check. Prior to this seal check, exhale quickly and vigorously to clear any obstructions within the exhalation assembly.

- Place the palm of your hand over the opening in the exhalation valve guard and exhale normally (Photo 12).
- If the facepiece bulges slightly and no air leaks between the facepiece and the face, an effective seal has been obtained.
- If air leaks out between the facepiece and the face, reset the facepiece and/or readjust the tension of the head straps to eliminate the leakage.
- This check must be repeated until an effective seal of the facepiece-to-face is obtained. If you cannot achieve an effective seal, do not enter the contaminated area. See your Supervisor.

SPECIAL USER'S INSTRUCTIONS

If the air-purifying cartridges have End-of-Service-Life Indicators (ESLI), you must be able to see the ESLI without moving the facepiece while wearing the respirator. See specific User Instructions supplied with the cartridges for additional ESLI information.

WARNINGS

If you remain in the contaminated area after the cartridges expire, you risk exposure to hazardous gases or vapors that could result in serious injury, illness or death.

Do not use the Backpack accessory with air-purifying cartridges that have ESLI because you will not be able to see the indicators while wearing the respirator. If you cannot see the indicators, you will not know when the cartridges have expired.

TO TAKE OFF THE RESPIRATOR

Before removing the respirator, go to a safe area with uncontaminated breathable air. Unhook the clip on the bottom strap and remove the respirator.

SERVICE LIFE

When used for gases or vapors having defined occupational exposure limits, you must follow a change-out schedule that will result in the cartridges being changed before the end of their useful life. See your supervisor about when to change the gas or vapor cartridges. If the cartridges have End-of-Service-Life Indicators, the cartridges must be changed when the color of either of the indicators matches the color standard indicated on the cartridge. Filters should be replaced when breathing becomes difficult.

NOTE

It is good hygiene practice to replace the air-purifying cartridges and/or filters after a single day of use, even if the service life of the air-purifying cartridges has not expired.

TURNAROUND MAINTENANCE

After each use, trained personnel should examine the respirator. All components of the respirator should be visually inspected prior to and after use. Check the inhalation and exhalation valves to ensure there is no debris, such as dirt or hair. Inspect all components of the facepiece and cartridges for damage, such as cracks, scratches, abrasions, deformation, tears, holes, or missing components. Replace any missing or damaged parts or discard the respirator and replace it with a new one.

DISASSEMBLY AND CLEANING

- Remove cartridges and/or filters from the connectors and discard them. Remove the Backpack Adapter, if used.
- Remove the head-band assembly, inhalation connectors, inhalation valves, exhalation-valve guard, valve and valve seat from the facepiece.
- Prepare a solution of cleaner/sanitizer (North P/N 80992) according to the instructions. Wash the facepiece and components in the cleaning solution.
- Rinse all components completely in clean warm water, then air dry in a clean area. Visually inspect the all components for damage. Replace if necessary.
- For light cleanings, a refresher wipe pad (North P/N 7003, 7003A) may be used to clean the portion that comes in contact with your face.

WARNING

Never allow cartridges or filters to come in contact with water or cleaning and sanitizing solutions. Moisture can damage the cartridges or filters and expose the user to the risk of serious illness or injury.

STORAGE

Store in a clean, dry area in the respirator storage bag provided with the facepiece.

CAUTION

Do not expose the respirator to excessive heat (above 140°F / 60°C), moisture, or contaminating substances during storage. Excessive heat may distort the facepiece and components resulting in the inability to achieve a proper fit.

INTRODUCTION

These instructions are for the North 5500 & 7700 Series Half Mask Air-Purifying Respirators. These air-purifying respirators consist of a facepiece assembly and a pair of replaceable air-purifying cartridges and/or filters. The facepiece, cartridges and/or filters may be sold separately.

These respirators are approved by the National Institute for Occupational Safety and Health (NIOSH) for respiratory protection against hazardous gases, vapors and/or particulates, depending on the air-purifying cartridges and/or filters used and the contaminant concentration and/or toxicity; but only if there is sufficient oxygen present in the contaminated atmosphere to support life.

TERMINOLOGY

Warnings, cautions and notes used in these instructions have the following significance:

NOTES

Procedures and techniques that are considered important enough to emphasize.

CAUTIONS

Procedures and techniques, which if not carefully followed, will result in damage to the equipment.

WARNINGS

Procedures and techniques, which if not carefully followed, will expose the user to the risk of serious injury, illness or death.

WARNINGS

Improper Use of Your Respirator Can Be Harmful or Deadly! For Your Safety, Read and Follow These Directives. If You Do Not Understand Them—Ask Your Supervisor!

- This instruction sheet is for your respirator in its original condition ONLY! These instructions DO NOT APPLY if your facepiece has been converted to a powered air-purifying or supplied-air respirator. If converted, see instructions for Compact Air PAPR (P/N CA102) or Airline Accessory (P/N CF2007).
- You MUST select a respirator approved for all the contaminants and concentrations in your work area. See the NIOSH Approval Label before use. Ask your supervisor to be sure you have the correct respirator.

WARNINGS

- NEVER use your respirator:
 - To perform or observe sand-blasting/abrasive-blasting;
 - To enter a sand-blasting/abrasive-blasting area unless air quality has been checked for contaminants;
 - To fight fires;
 - In any atmosphere with less than 19.5% oxygen at sea level;
 - In atmospheres where contaminants and/or concentrations are unknown or pose immediate danger from toxics, corrosives or asphyxiates;
 - When contaminant concentrations exceed 10 times the permissible exposure limit (PEL) set by OSHA or other government regulations;
 - To protect against particulates containing oil unless a NIOSH "R" or "P" filter is used;
 - To protect against gases or vapors without using air-purifying cartridges that have End-of-Service-Life-Indicators (ESLI) or a cartridge change schedule based on service-life data; or
 - To protect against gases or vapors not adsorbed by the sorbent material, such as Methanol.
- NEVER use your respirator if you cannot achieve a good facepiece-to-face seal due to:
 - Facial hair;
 - Eyewear that interferes with facepiece-to-face seal;
 - Head or face coverings, jewelry or other accessories that interfere with sealing area; or
 - Missing teeth, dentures, facial deformities or deep scars.
- IMMEDIATELY leave work area and remove the respirator if:
 - Breathing becomes difficult;
 - You become dizzy or disoriented;
 - You no longer have a good facepiece-to-face seal;
 - You smell, taste or otherwise sense contaminants; or
 - Your respirator is damaged.
- REMEMBER:
 - Any air-purifying respirator, when properly selected and fitted, will significantly reduce, but will not completely eliminate, the breathing of contaminant(s) by the respirator wearer. When working in atmospheres containing substances which are reported to cause cancer in amounts below their permissible exposure limit, you will obtain better protection from a powered air-purifying respirator, continuous flow or positive pressure air supplied respirator, or self-contained breathing apparatus (an SCBA).
 - Your respirator will not protect exposed areas of face or body from gases, vapors or airborne particles that can irritate, burn or be absorbed through your skin—wear hand and/or body protection.

TRAINING PROGRAM

These brief written instructions cannot substitute for a formal Respirator Training Program. Training should be performed with a Safety Manager to ensure you are trained in the proper use of respirators, including putting on and removing them. Your training should include an opportunity for you to handle the respirator, learn how to inspect it, have it properly fitted, test its facepiece-to-face seal and wear it in an area with uncontaminated air while becoming familiar with it. You must inspect the respirator before and after each use to ensure that it is in good working condition.

Training Programs in the U.S. should be based on ANSI Z88.2-1992, OSHA Regulation 29CFR Section 1910.134 and other regulations promulgated by various Regulatory Authorities. In Canada, the training program should be based on CSA Standard Z94.4-93.

FIT TESTING

Before you are assigned a respirator, you should have a qualitative or quantitative fit test to make sure it fits correctly. Ask your supervisor about these fit tests.

The North 5500 and 7700 facepieces are available in three overlapping sizes: small, medium and large. The size is indicated by an "S," "M," or "L" molded onto the exterior of the facepiece. Most faces can be fit with one of these three sizes. In addition, your respirator should be fit-tested at least once a year or any time there are changes that may affect the fit of the respirator, such as weight changes or dental surgery.

Qualitative fit test kits (North P/N 770039 and 770040) and a quantitative fit test adapter (North P/N 770021) are available for conducting fit tests. Qualitative fit testing instructions come with the qualitative fit test kits. Instructions for qualitative and quantitative fit testing are given in OSHA 29 CFR §1910.134 Appendix A, and respirator manuals published by government agencies such as NIOSH, ERDA, and NRC.

ASSEMBLING THE RESPIRATOR

Remove the facepiece assembly from its container and visually check the facepiece to make sure that the sealing flange is not distorted and that all components, including the exhalation valve, are in place and in good condition.

If replaceable pad-style filters are required, assemble filters securely to the cartridges or filter holders before the cartridges or filter holders are attached to the facepiece. Place the filters in the appropriate filter cover so that the outer edges of the filters are seated evenly and securely against the inner wall of the filter covers (Photo 1). With the filters seated evenly and securely, snap the cover onto the cartridge or filter holder (Photo 2)

To assemble the respirator, attach the appropriate air-purifying cartridges and/or filters onto the cartridge connectors mounted on the facepiece. Check to be sure that the cartridges and/or filters are effectively sealed against the facepiece (Photo 3).

WARNING

The NIOSH Approval and all North warranties for this respirator are nullified if cartridges and/or filters from other manufacturers are used.

If using the Backpack Adapter (North P/N BP1002), attach the backpack to the facepiece cartridge connectors, and fasten the appropriate cartridges and/or filters to the backpack mounting plate (Photo 4). Check to be sure that the cartridges and/or filters are effectively sealed against the rubber gasket attached to each back plate connector.